

RANGE COMPOSITION

N 900: a range of over 150 models for the professional caterer designed to guarantee the highest level of performance, reliability, energy saving, safety standards and ergonomic operation. These concepts are reflected in the total modularity of the range that ensures innumerable configurations, either free-standing, bridged or cantilever. N900 demonstrates how advanced technology can satisfy the needs of the professional caterer. The models detailed in this sheet are 8 electric fry tops in full module version with smooth or 2/3 smooth and 1/3 ribbed plates in mild steel or chrome-plated steel, ideal for the simple, oil-free cooking of fish, meats and vegetables.



200211

N 900

FULL MOD. ELECTRIC FRY TOPS-THERMOSTATIC

ZANUSSI
PROFESSIONAL

FUNCTIONAL AND CONSTRUCTION FEATURES

- ◆ Incoloy heating elements positioned under the cooking plate.
- ◆ Safety thermostat and thermostatic control (temperature markings in °C for thermostat

control).

- ◆ Worktop in 20/10 stainless steel with Scotch Brite finish.
- ◆ All models have right-angled side edges to allow flush fitting joints between units eliminating gaps and possible dirt traps.
- ◆ The new embedded deep drawn design avoids fat infiltration behind the appliance

improving hygienic conditions.

- ◆ Cooking surface with rounded corners, available in mild steel or chrome-plated mild steel (smooth or 2/3 smooth and 1/3 ribbed surface) for optimum grilling results.
- ◆ Removable higher splashback

TECHNICAL DATA		MODELS							
CHARACTERISTICS	NRE8HMS 200211	NRE8SMM 200213	NRE8SCS 200215	NRE8SCM 200216	NRE8HMS2 200219	NRE8SMM2 200220	NRE8SCS2 200222	NRE8SCM2 200223	
Power supply	Electric	Electric	Electric	Electric	Electric	Electric	Electric	Electric	
External dimensions - mm									
width	800	800	800	800	800	800	800	800	
depth	900	900	900	900	900	900	900	900	
height	250	250	250	250	250	250	250	250	
Cooking surface									
type	Smooth	Smooth/Ribbed	Smooth	Smooth/Ribbed	Smooth	Smooth/Ribbed	Smooth	Smooth/Ribbed	
material	Mild Steel	Mild Steel	Chromium Plated	Chromium Plated	Mild Steel	Mild Steel	Chromium Plated	Chromium Plated	
Sloped Cooking Surface		●	●	●		●	●	●	
Flat Cooking Surface	●				●				
Thermostatic valve	●	●	●	●	●	●	●	●	
Cooking surface dimensions - mm									
width	730	730	730	730	730	730	730	730	
depth	700	700	700	700	700	700	700	700	
Working temperature - min/max - °C	120, 280	120, 280	120, 280	120, 280	120, 280	120, 280	120, 280	120, 280	
Power - kW									
installed-electric	15	15	15	15	15	15	15	15	
Net weight - kg.	105	105	105	105	105	105	105	105	
Supply voltage	400 V, 3N, 50/60	400 V, 3N, 50/60	400 V, 3N, 50/60	400 V, 3N, 50/60	230 V, 3, 50/60	230 V, 3, 50/60	230 V, 3, 50/60	230 V, 3, 50/60	
INCLUDED ACCESSORIES									
SCRAPER FOR RIBBED PLATE FRY TOP		1		1		1		1	
SCRAPER FOR SMOOTH PLATE FRY TOP	1	1	1	1	1	1	1	1	
STOPPER FOR FRY TOP HORIZONTAL PLATE	1				1				

- ◆ Cooking surface equipped with a grease collection channel which drains the grease into a hole, conveying it in a 3-lt collector placed under the surface.
- ◆ Constructed to avoid accidental tilting of the collector.
- ◆ The chrome plate allows energy to be transferred directly to the food and not towards the operator.
- ◆ The special labyrinth design of the control knob system avoids infiltration of liquids.
- ◆ Main connections can be via the base or rear of unit.
- ◆ Quick heat-up time.
- ◆ Separate controls for each ½ zone of the cooking surface to reach intermediate temperatures between low and high for each ½ zone as well as the heating of a single zone to cook small quantities, thus saving energy.
- ◆ All top models can be easily mounted on refrigerated base, open base cupboards, bridging supports or cantilever systems.
- ◆ IPX5 water protection.

Productivity/h (full module, chromium plated)

- ◆ 210 Hamburger fresh 100 gr
- ◆ 240 Pilard of veal 80 gr
- ◆ 336 Sliced oubergine 1 cm
- ◆ 168 Sausages 100 gr cut lengthways
- ◆ 300 Sliced zucchini 1/2 cm
- ◆ 112 Pork ribs 160 gr
- ◆ 240 Sliced turkey 100 gr
- ◆ 108 Sliced salmon 200 gr

Productivity/h (full module, mild steel)

- ◆ 252 Hamburger fresh 100 gr
- ◆ 360 Pilard of veal 80 gr
- ◆ 384 Sliced oubergine 1 cm
- ◆ 168 Sausages 100 gr cut lengthways
- ◆ 300 Sliced zucchini 1/2 cm
- ◆ 112 Pork ribs 160 gr
- ◆ 240 Sliced turkey 100 gr
- ◆ 108 Sliced salmon 200 gr

OPTIONAL ACCESSORIES								
ACCESSORIES	MODELS							
	NRE8HMS 200211	NRE8SMM 200213	NRE8SCS 200215	NRE8SCM 200216	NRE8HMS2 200219	NRE8SMM2 200220	NRE8SCS2 200222	NRE8SCM2 200223
2 SIDE COVERING PANELS FOR TOP-D=900MM	206278	206278	206278	206278	206278	206278	206278	206278
CHIMNEY UPSTAND 800MM	206304			206304				
FRONTAL HANDRAIL 1200 MM	206191	206191	206191	206191	206191	206191	206191	206191
FRONTAL HANDRAIL 1600 MM	206192	206192	206192	206192	206192	206192	206192	206192
FRONTAL HANDRAIL 400 MM	206166	206166	206166	206166	206166	206166	206166	206166
FRONTAL HANDRAIL 800 MM	206167	206167	206167	206167	206167	206167	206167	206167
JUNCTION SEALING KIT	206086	206086	206086	206086	206086	206086	206086	206086
LARGE HANDRAIL(PORTIONING SHELF)400 MM	206185	206185	206185	206185	206185	206185	206185	206185
LARGE HANDRAIL(PORTIONING SHELF)800 MM	206186	206186	206186	206186	206186	206186	206186	206186
PAIR OF COVERING STRIPS FOR END ELEMENTS	206234	206234	206234	206234	206234	206234	206234	206234
SCRAPER FOR RIBBED PLATE FRY TOP		164257		164257		164257		164257
SCRAPER FOR SMOOTH PLATE FRY TOP	164255	164255	164255	164255	164255	164255	164255	
SIDE HANDRAIL-RIGHT/LEFT HAND	206165	206165	206165	206165	206165	206165	206165	206165
STAND/SUPPORT 400 MM	206183	206183	206183	206183	206183	206183	206183	206183
STAND/SUPPORT 800 MM	206184	206184	206184	206184	206184	206184	206184	206184
STOPPER FOR FRY TOP HORIZONTAL PLATE	206296				206296			
WATER COLUMN EXTENSION FOR 900 LINE	206290	206290	206290	206290		206290	206290	206290
WATER COLUMN WITH SWIVEL ARM	206288	206288	206288	206288		206288	206288	206288
WATER DRAIN FOR FRY TOP FULL MODULE	216153	216153	216153	216153	216153	216153	216153	216153
WATER DRAIN FOR FRY TOP HALF MODULE	206153	206153	206153	206153	206153	206153	206153	206153



www.zanussiprofessional.com

200211, 200223, 200222, 200220, 200219, 200216, 200215, 200213

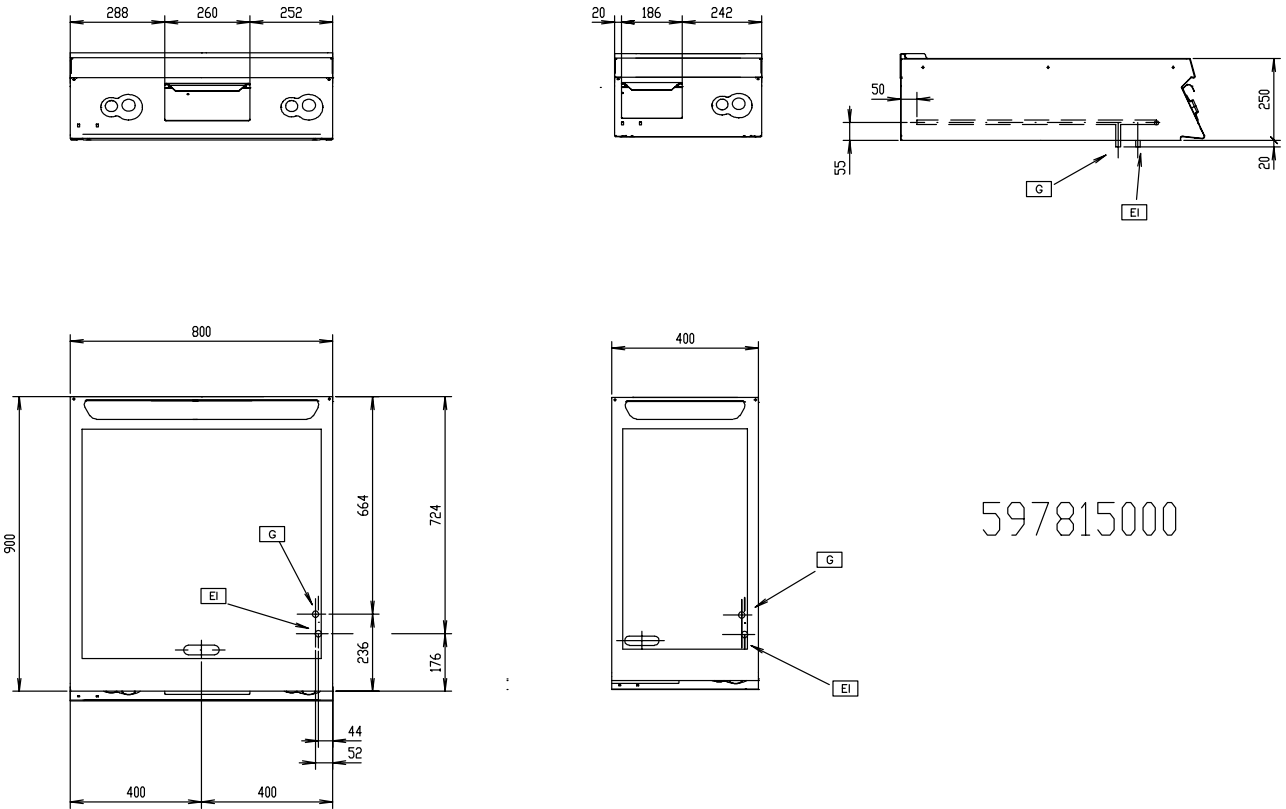

LEGEND

	NRE8HMS 200211	NRE8SMM 200213	NRE8SCS 200215	NRE8SCM 200216	NRE8HMS2 200219	NRE8SMM2 200220	NRE8SCS2 200222	NRE8SCM2 200223
EI - Electrical connection	400 V, 3N, 50/60	400 V, 3N, 50/60	400 V, 3N, 50/60	400 V, 3N, 50/60	230 V, 3, 50/60	230 V, 3, 50/60	230 V, 3, 50/60	230 V, 3, 50/60



www.zanussiprofessional.com